

NOTE:
ESCAPE RAMPS MUST BE CONSTRUCTED AND MAINTAINED DURING NON-WORKING HOURS WHERE A VERTICAL DROP GREATER THAN 2 INCHES EXISTS ADJACENT TO TRAVELED LANE.

ESCAPE RAMP DETAIL

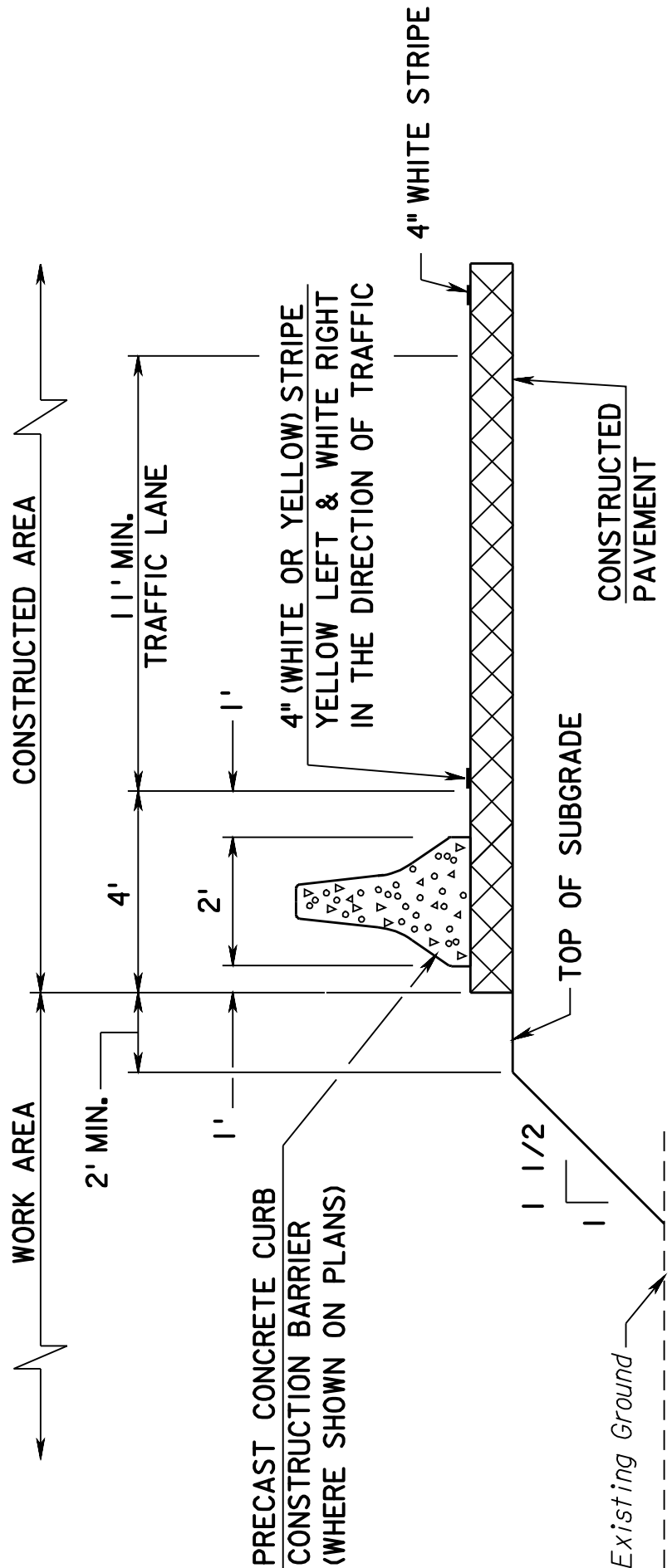

PLACEMENT OF PRECAST CONCRETE CONSTRUCTION BARRIER

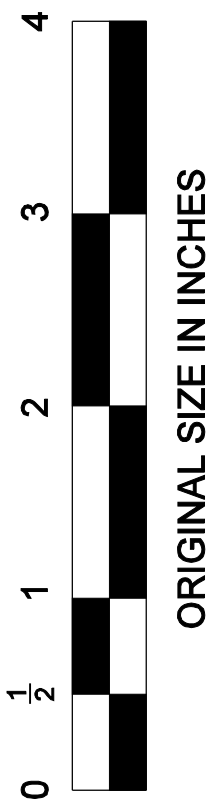

NEW JERSEY TURNPIKE AUTHORITY
ROADWAY NAME
PROJECT DESCRIPTION

CONTRACT NO.

MAINTENANCE AND PROTECTION OF TRAFFIC DETAILS

NAME OF CONSULTANT	ADDRESS	CERTIFICATE OF AUTHORIZATION NO. XXXXXXXXX	SCALE: NONE	8
JOHN DOE			DATE: MAY 2008	69
NEW JERSEY PROFESSIONAL ENGINEER LICENSE NO. XXXXXXXXXX				

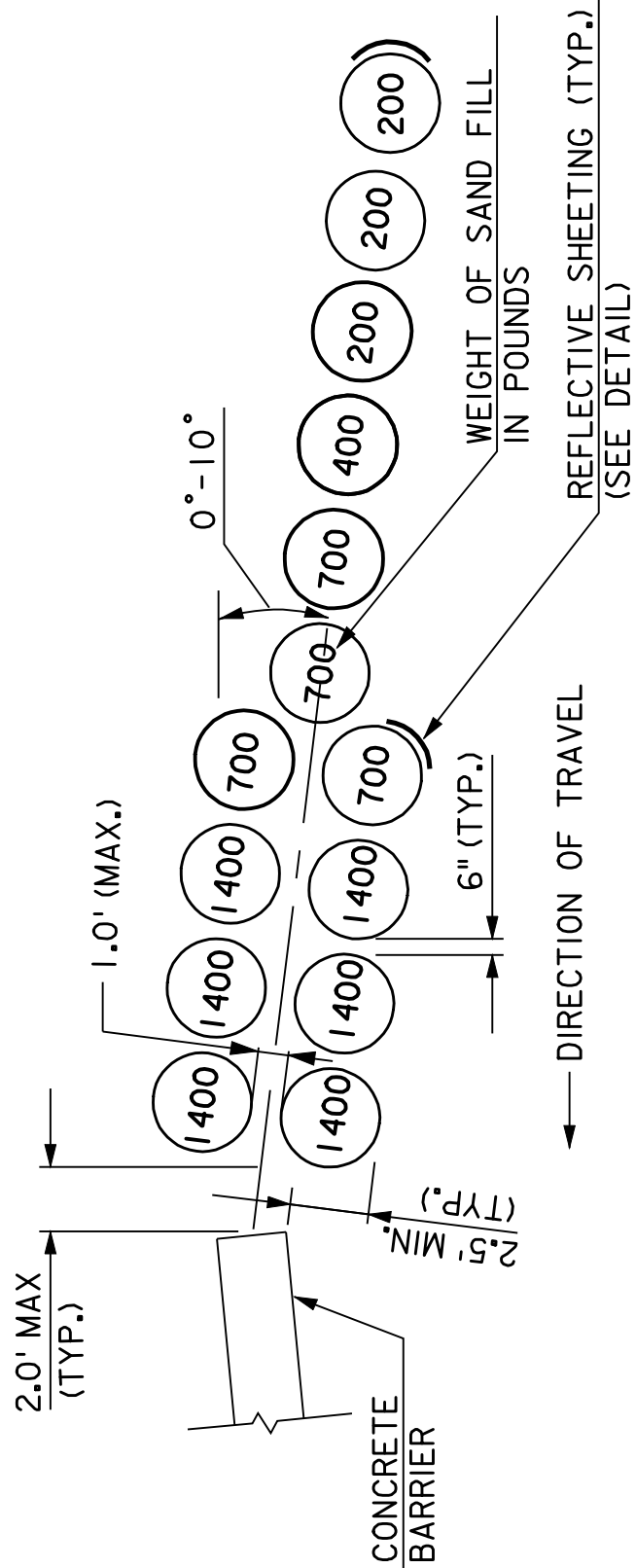

TEMPORARY IMPACT ATTENUATOR

(DESIGN SPEED = 60 MPH)

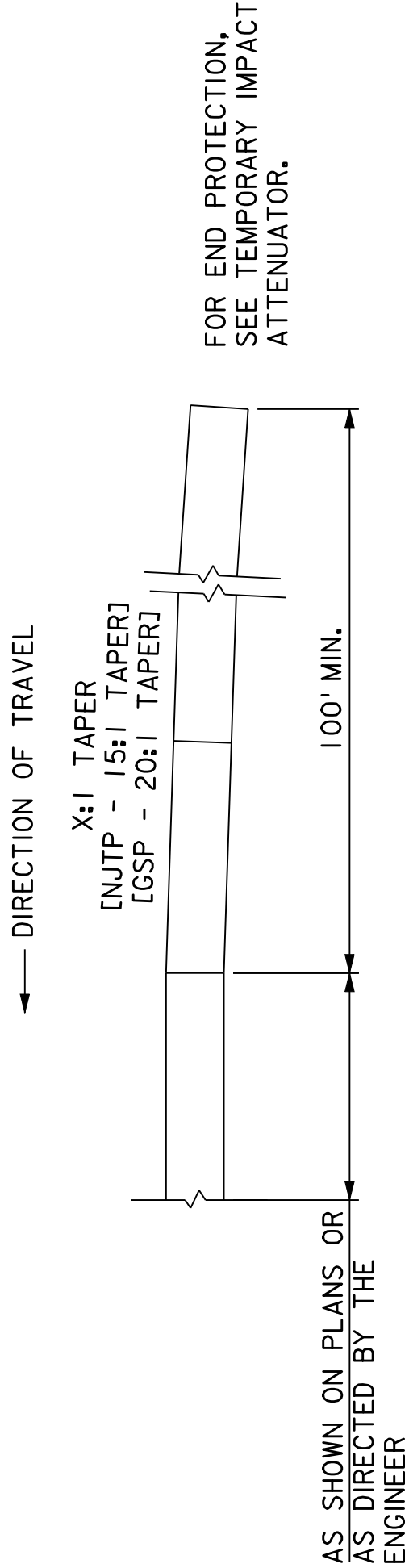

CONCRETE CONSTRUCTION BARRIER END TREATMENT

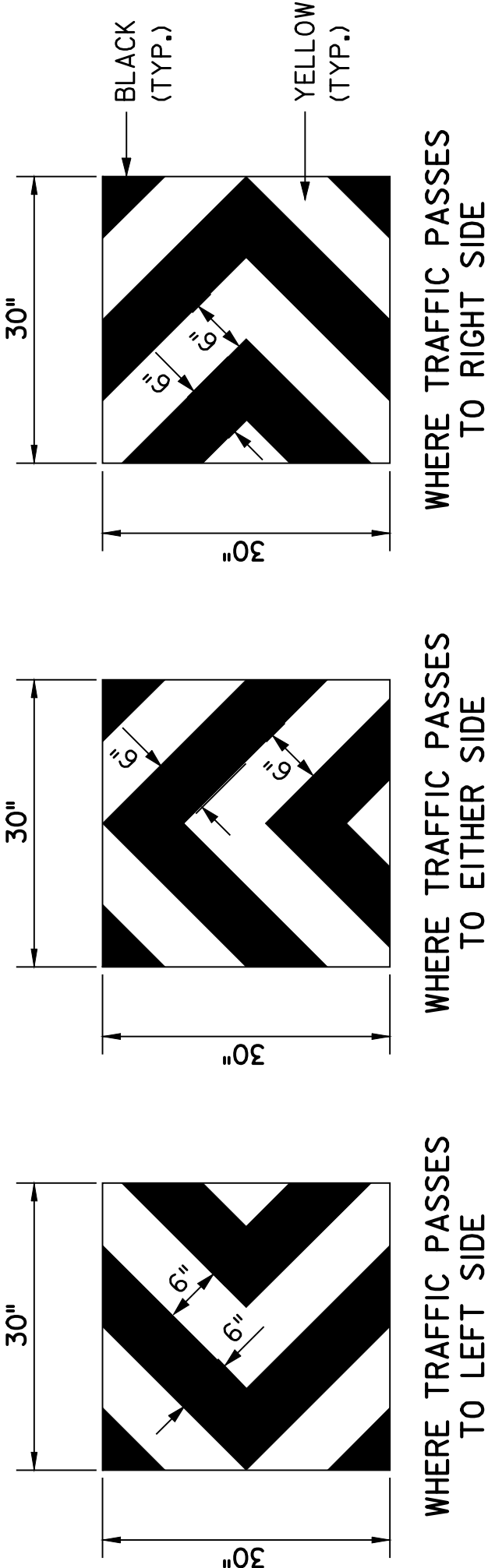

REFLECTIVE PANEL DETAIL

LOCATIONS WHERE IMPACT ATTENUATORS ARE USED: ON THE SMOOTH SURFACE OF THE "BELLY BAND" OF HYDROCELL TYPES AND ENERGITE TYPE BARRELS, INSTALL A 30" X 30" PIECE OF HIGH INTENSITY, COLD APPLICATION, HI TACK OR SUPER HI TACK SHEETING WITH EITHER OF THE THREE APPROPRIATE CROSS HATCHING SCHEMES AS SHOWN ABOVE ON "FITCH TYPE BARRELS, DUE TO THE RIGID SURFACE, THE SHEETING MAY HAVE TO BE MOUNTED ON "LIGHT" STOCK AND BE POP-RIVETED ON THE LEAD DRUM.

MADE	BY	DATE
TRACED	XXX	XX-XX-XX
CHECKED	XXX	XX-XX-XX
SUPERVISED	XXX	XX-XX-XX